

Henderson Panoramic Sectional Overhead Doors

METALBILT DOORS

These doors are the pinnacle of innovation and functionality in industrial and commercial door solutions.

OVERVIEW

- Each door purpose made to your requirement of size, type and application.
- Completely clear openings.
- Track arrangements to suit different structural conditions.
- Weathertight closure, keeps cold out and heat in.
- No floor channel.
- Easy and fast counterbalanced operation.
- Maximum glazing if required.
- Minimum maintenance and easy repair.
- Prices competitive with other door systems.
- Full range of options including automatic operation. Installation and aftersales service

Panoramic Sectional and Roller Shutter Doors are provided on a supply only or supply and install basis. This service applies throughout New Zealand. We are also able to offer a long-term service and maintenance contract to ensure that your Henderson Panoramic Sectional Overhead Doors are always in first class working order and that any damage can be rectified without delay.

SPECIFICATIONS

Stiles and Rails:

- Extruded anodised aluminium alloy (B.S.S. 1476/HE9TF and B.S.S. 1615) to give a nominal 44mm (1 $\frac{3}{4}$ ") thick door
- Top and bottom rails 95mm (3 $\frac{3}{4}$ ") deep
- Intermediate rails 56mm (2 $\frac{3}{16}$ ") deep per pair and incorporating weather rebates
- Intermediate stiles 32mm (1 $\frac{1}{4}$ ") wide
- End stiles 60mm (2 $\frac{1}{2}$ ") wide
- All meeting rails have an integrally extruded reinforcing brace

Panels:

- Colour coated aluminium – plain sheet for infilled sections
- 1.27mm (0.05") thick.
- Colour as required

Bracing:

- Additional bracing for wide doors where necessary

Weatherstrip:

- PVC section to bottom rail

Locking:

- Internal system with quick-release mechanism mounted on right hand end stile (viewed internally)
- Lock shoot engages in vertical track
- External locking with key cylinder available as an optional extra.

Sections:

- Stiles and rails secured by 6.4mm (1/4") diameter steel rods
- Open for glazing or aluminium infill panels

FINISH

- All or any selected sections can be glazed
- Standard glass 4mm toughened or 6.38 laminated
- It is recommended that colour Coated aluminium panels be used in the bottom section
- Glazing and panels secured by snap-in rigid vinyl moulding together with butyl strip to achieve a weathertight installation

WEIGHT

14kg/m2 (2.91b/ft^2)

Drawings

The following drawings show the six different track configurations available for Henderson Panoramic Sectional Overhead Doors. Please contact us for a full range of information on this door.

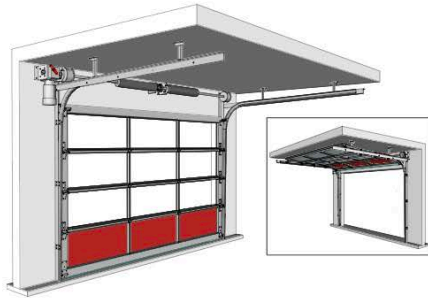

Standard Headroom

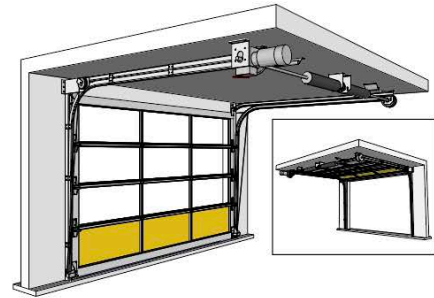

Low Headroom

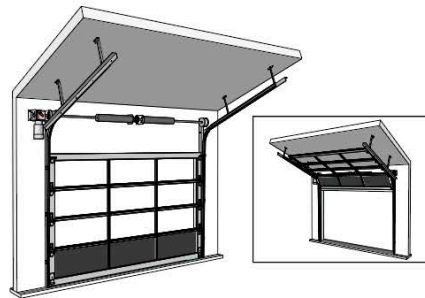

Follow The Roof

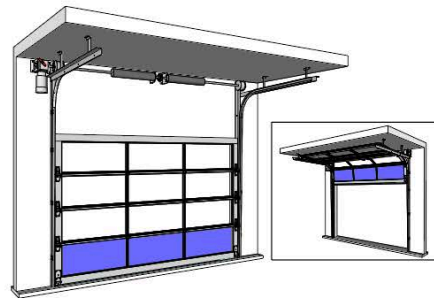

Lift Clear

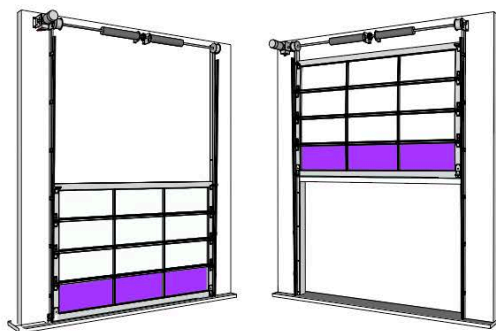

Full Vertical

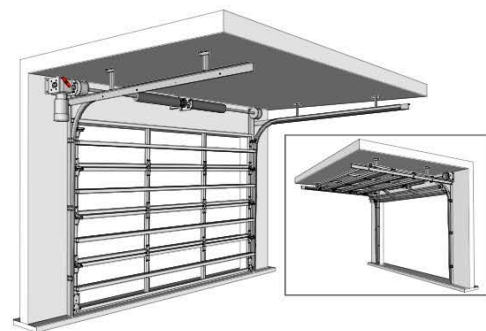

**Steel Frame -
Standard Headroom**

Projects

