

Security Roller Grilles

METALBILT SHUTTERS

Your choice of light or heavy-duty rolling security grilles to suit your needs.

Our security roller grille offers high security, visibility and ventilation for a wide variety of applications.

OVERVIEW

Metalbilt's security roller grille is custom designed to suit and come in two sizes – light duty 12mm aluminium tube or heavy duty 19mm aluminium tube. Both grilles are curtain assembled from tubes and moulded nylon links into a brick pattern for added strength.

Available in a wide range of colours to suit your requirements.

APPLICATIONS

12mm tube light duty grille recommended for:

- Bar tops
- Counter tops
- Shop fronts
- Pedestrian openings
- Arcades

19mm tube heavy duty grille recommended for:

- Carparks
- Shopfronts
- Large pedestrian openings
- Industrial buildings

SIZE

12 mm tube size:

- Maximum width – 5.5 metres
- Maximum height – 4 metres

19 mm tube size:

- Maximum width – 10 metres
- Maximum height – 5 metres
- Maximum opening – 40m²

Technical Specifications

SPECIFICATIONS

12mm - Standard Specifications

Curtain: Assembled from 12mm aluminium tubes and moulded nylon links into a brick pattern. The tubes and links can be replaced individually, if damaged.

Bottom bar: Fitted to the lower edge of the curtain is an extruded aluminium bottom bar.

Guides: Specially extruded aluminium channel 40mm x 30mm. Guides screw to jambs at maximum 600mm centres.

Barrel: Barrels are fabricated from mild steel tube with a minimum diameter of 165mm. Helically wound counterbalance springs are contained within the barrel.

Security: Flush mounted lock with various keying options.

Operation: Spring balanced or motorised. Motorised grilles have a single phase low cycle motorising (LCM) with adjustable limit switches and control pendant. Operating speed is approx. 200mm per second.

Optional extras:

- Low side room available for tight installations
- Fixed and lift out mullions
- Battery back up system
- Key switches and door controllers that accept signals from a range of activation features
- Special motorising options and barrel mounting methods

19mm - Standard Specifications

Curtain: Assembled from 19mm aluminium tubes at a nominal vertical pitch of 75mm joined by 35mm wide extruded aluminium links spaced at 500mm. Every sixth rod has a retaining plug secured to each end to retain the curtain within the guide section. The tubes and links can be replaced individually, if damaged.

Bottom bar: Fitted to the lower edge of the curtain is a 100mm x 25mm extruded aluminium box section bottom bar.

Captive guides: Constructed from extruded aluminium with a retaining nib and fitted with a continuous silicon treated polypropylene pile insert to prevent metal on metal contact.

Barrel: Barrels are fabricated from mild steel tube with a minimum diameter of 165mm. Helically wound counterbalance springs are contained within the barrel.

Security: To enhance security, the curtains are supplied with Metalbilt's lifting deterrent mechanism.

Electrical operation: The compact motorising units are powered by a three phase 0.37kW electric motor, driving an enclosed worm gearbox with chain reduction to the shutter barrel. Supplied complete with reversing starter and limit switches. Operating speed is approx. 200mm per second.

High cycle operation: Designed for use in car parks, the grilles are supplied with a three phase brake motor and TER limit switch, nylon bushes on the end of each tube, steel bell mouth support and steel pipe barrel.

Optional extras:

- Low side room available for tight installations
- Fixed and lift out mullions
- Battery back up system
- Key switches and door controllers that accept signals from a range of activation features
- Special motorising options and barrel mounting methods

FINISH

Clear anodised or powder-coat available.

Clearances and Specifications

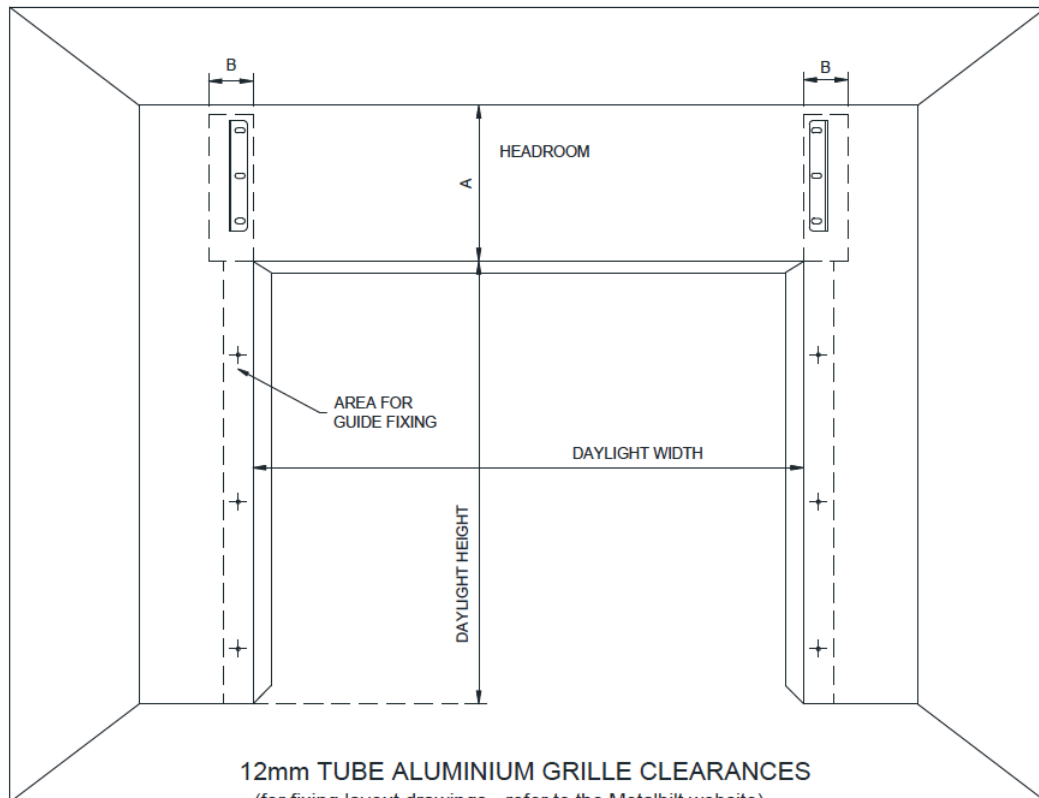

HEIGHT OF OPENING	HEADROOM	SIDEROOM	INSIDE PROJECTION BARREL	INSIDE PROJECTION MOTOR	GUIDE PACKER SIZE
	A	B	C	D	E
0 - 1.25	380	120	330	605	0
1.25 - 2.0	410	120	380	635	0
2.0 - 3.0	450	120	415	650	40
3.0 - 4.0	500	120	450	715	50

For max sizes refer to the Security Grille and Shutter Selection Chart
(Available on the Metalbilt website)

GUIDE DETAILS

Packer by others (to lintel only)

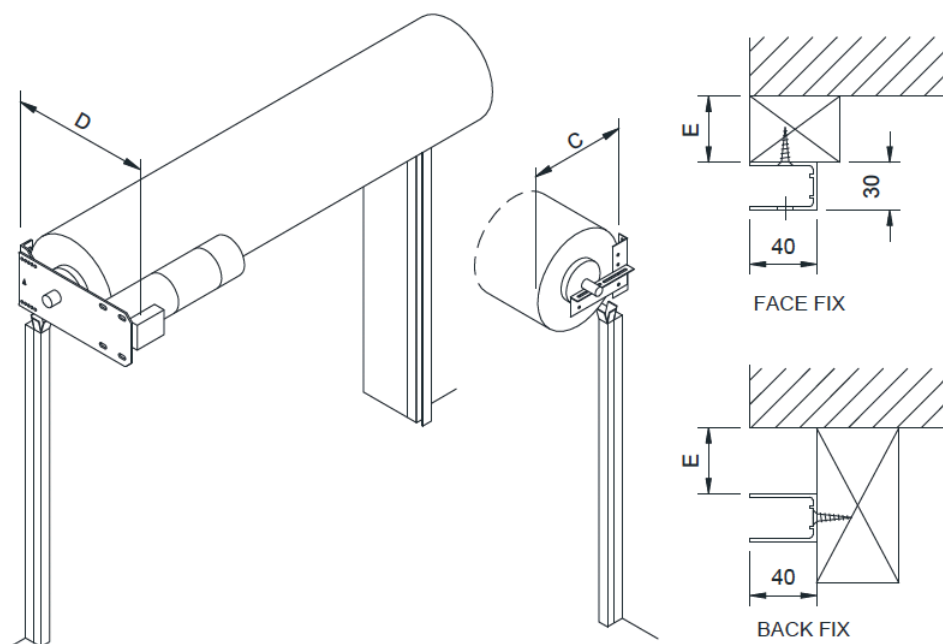

We reserve the right to alter specification without notice and without incurring obligation.

Clearances and Specifications

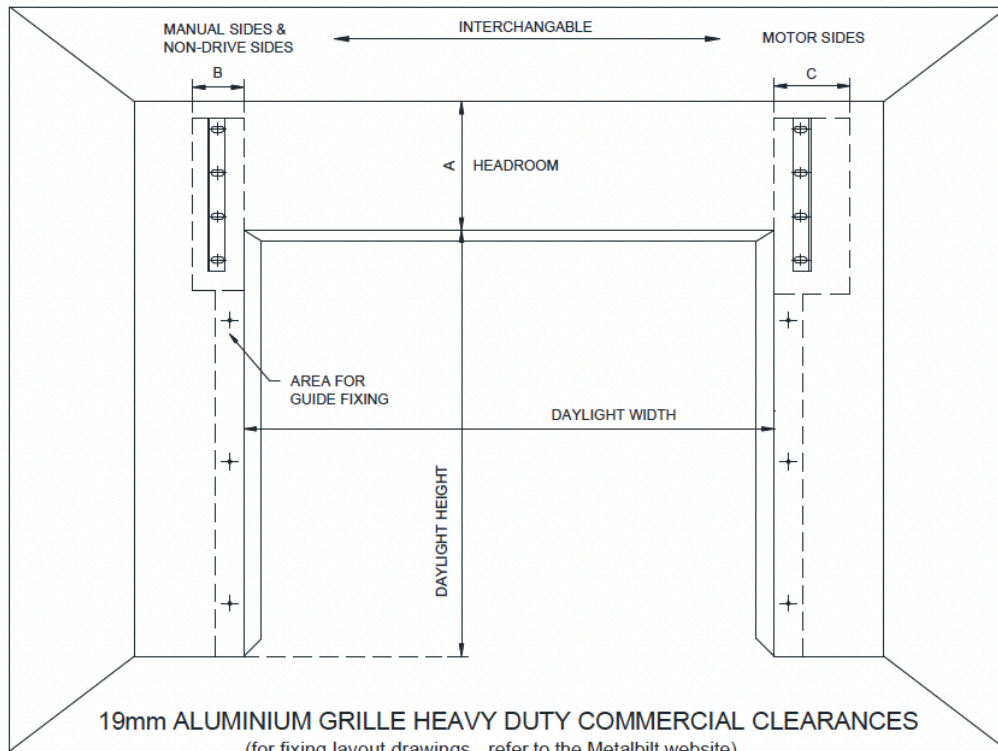

HEIGHT OF OPENING	HEADROOM	SIDEROOM Non-Drive & Manual	SIDEROOM Motor side	INSIDE PROJECTION MOTORISED*	INSIDE PROJECTION BARREL	GUIDE PACKER SIZE
(m)	A	B	C	D	E	F
0 - 2.5	450	145	215	565	415	0
2.5 - 3.0	475	145	215	580	455	46
3.0 - 4.0*	515	145	215	595	485	46
4.0 - 5.0	550	145	215	610	515	46
5.0 - 6.0	565	145	215	610	530	46

* Brake motor 630mm projection if required

For max sizes refer to the Security Grille and Shutter Selection Chart
(Available on the Metalbilt website)

GUIDE DETAILS

Packer by others (to lintel only)

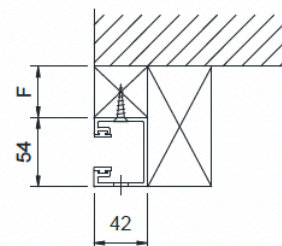

BACK OR SIDE FIX

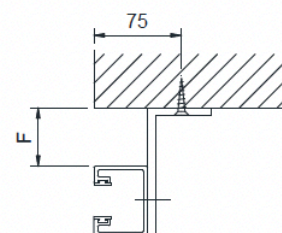

100x50 ANGLE OPTION

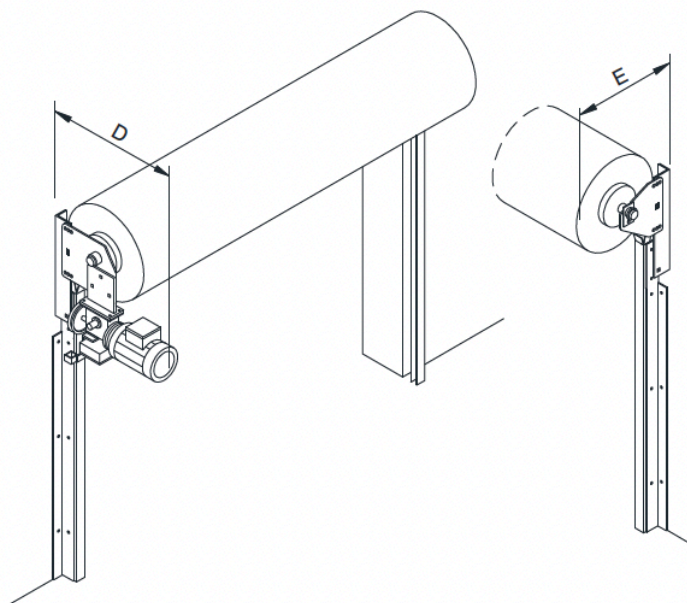

We reserve the right to alter specification without notice and without incurring obligation.

Projects

